



NL: Assemblage X-Stream / EN: Assembly X-Stream / FR: Assemblage X-Stream / DE: Zusammenbau X-Stream

NL: Belangrijk: De wand rondom het gat moet volkomen egaal/vlak zijn
FR: Important: le mur autour du doit être complètement égal et lisse.

EN: Important: The wall around the hole should be completely flat/even
DE: Wichtig: Die Wand ringsum das Loch muß vollkommen flach/eben sein.



NL: Montageset
EN: Mounting set
FR: Set de montage
DE: Montageset

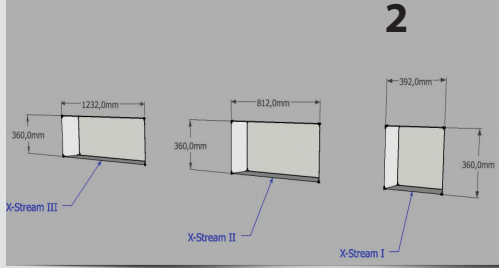

NL: Inbouwmaten
EN: Installation measurement details
FR: Dimensions ouvertures
DE: Aussparungsmaße

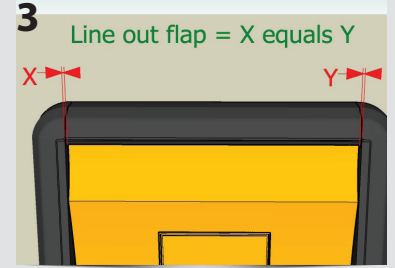

NL: Uitleggen : X = Y
EN: Line out : X = Y
FR: Aligner : X = Y
DE: Ausrichten : X = Y



NL: a = Standaard b = Bij betonkader
EN: a = Standard b = With framework
FR: a = Moyenne b = Chez cadre béton
DE: a = Standard b = Bei Betonrahmen

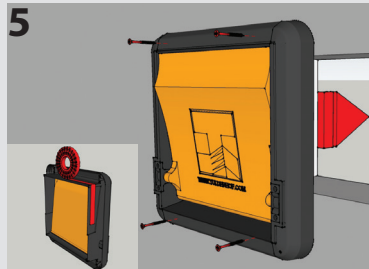

NL: Plaats & schroef -optie zwelband
EN: Place & screw - option swelling tape
FR: Placez et visser - option compribande
DE: Stellen & schrauben - opt. Schwellband

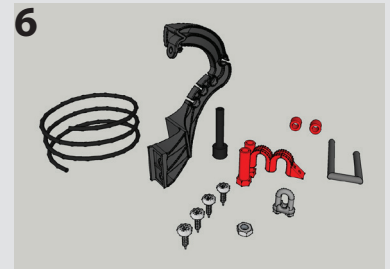

NL: Aansluitset
EN: Connecting set
FR: Set de connection
DE: Anschlußgarnitur

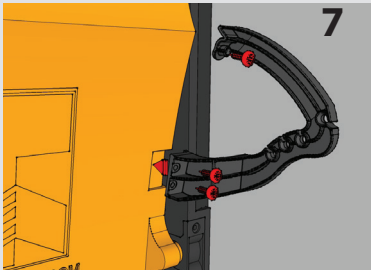

NL: Schroef houder
EN: Screw holder
FR: Vissez la pièce
DE: Schrauben das zubehörteil

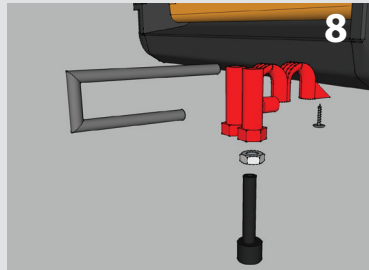

NL: Plaatsen U-as en katrol
EN: Place U-axis & pulley
FR: Placez U-axe & poulie
DE: Stellen das U-Welle & Rolle

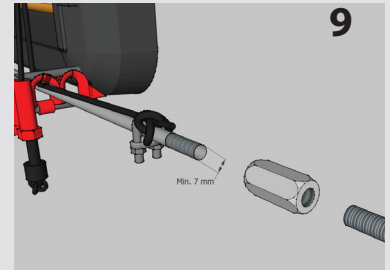

NL: Gebruik minimaal 7 mm staaf
EN: Use 7 mm rod or bigger
FR: Au minimum une barre 7 mm
DE: Minimal 7 mm Stange

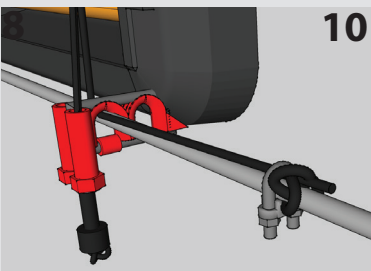

NL: Plaatsen touw
EN: Place the rope
FR: Placez la corde
DE: Stellen das Seil

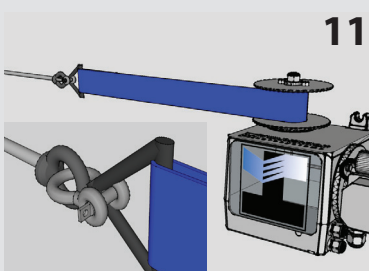

NL: Sluit de staaf op de motor aan
EN: Connect rod to winch
FR: Connecter barre et treuil
DE: Verbinde Stange mit Stellmotor

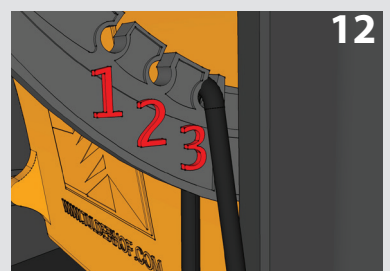

NL: 1 op 3 systeem (maak uw keuze)
EN: 3 in 1 System (make your choice)
FR: 1 sur 3 système (fait votre choix)
DE: 1 zu 3 System (treffen Sie Ihre Wahl)