

## Black out ridge

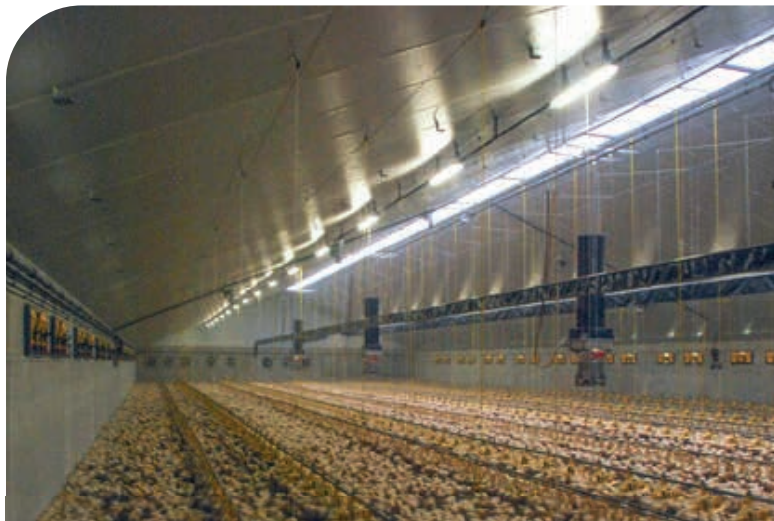

Beautiful light distribution

New houses

Gradually black out system

3% and/or 20 Lux

High insulation value

### Perfect solution

A blackout ridge is a very nice solution to get daylight into a poultry or pig house.

Daylight from the roof gives the best light distribution across the building, also when the ridge is partly closed.

### Layer houses not wider than 24 meters

According to Kat Regulations daylight has to be within 12 meters of the animals. Therefore, one cannot go wider than 24 meters with a dark out ridge.

### Broilers with daylight

The most common norm is 3% of the ground surface. This should be installed as daylight in the roof (Germany, England, France etc.)

With a black out ridge one can easily meet these regulations. With 3% daylight installed, one is also certain of 20 Lux in the house.

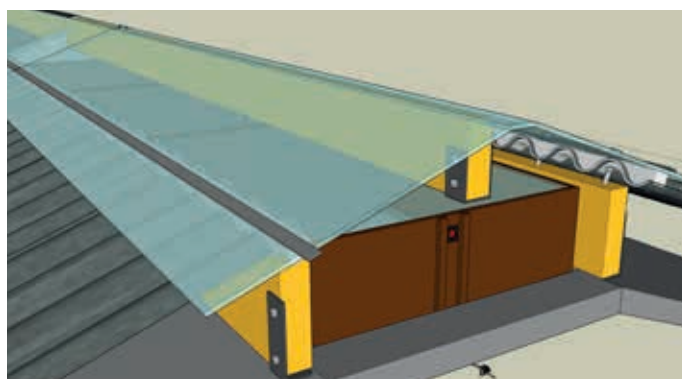

## Technical information

### Technical

Below you can see a technical drawing of a blackout ridge. This ridge is suitable for newly built stables. For a good connection it is important that the uppermost purlins stand straight in the L-structure.

On top of the roof lies a 10 mm polycarbonate plate, beneath lies a 25 mm polycarbonate plate.

Together they provide a good insulation.

Type	R (m <sup>2</sup> .K/W)	U (W/m <sup>2</sup> .K)
Ridge HR+ 0-25	1.99	0.50
Ridge HR+ 10-25	2.38	0.42
Ridge HR+ 25-25	2.71	0.37

\* values of the corrugated sheet are exclusive

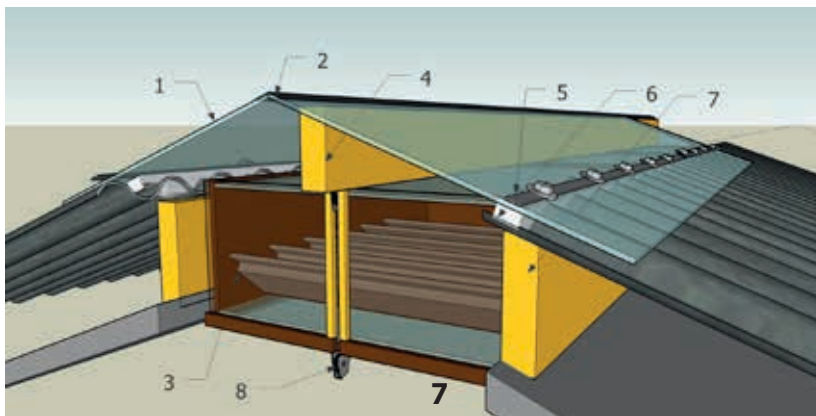

### Legenda

- 1 = 10 mm polycarbonate
- 2 = Plastisol top ridge fla
- 3 = Ridge with HR+ slats
- 4 = Ridge beam
- 5 = Alu strip 40 x 4 mm
- 6 = Sealing foam
- 7 = Purlin (upright)
- 8 = Bottom pulley



HR+ slats

Tulderhof Ventilation BV • Looyenbeemd 10 • 5652 BH Eindhoven • Netherlands  
 Tel. +31 (0) 404 00 63 13 • Tel. +32 (0) 14 65 86 91 • Fax +32 (0) 14 65 99 60

WWW.TULDERHOF.COM